

High Power

SEN CV 035 Indoor Fixture Guide

KKDÖ

Indoor | Surface | Output up to 3404lm/m (1038lm/ft)



Key applications

- ✓ Direct lighting
- ✓ Downlighting
- ✓ Flood lighting
- ✓ Interior
- ✓ Retail display
- ✓ Uplighting
- ✓ Wall grazing
- ✓ Window reveal

Key features

- ✓ Adjustable
- ✓ Custom lengths
- ✓ Constant Voltage (CV)
- ✓ Diffusion: spoting
- ✓ IP40 dry area.
- ✓ Lens options

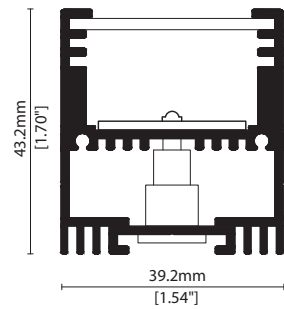

MOUNTING METHODS



KKCP-12 Lock clip



KKBK-02 Fixed bracket



KKBK-09 Mounting plate



KKBK-16 Small adjustable bracket



KKBK-17 Large adjustable bracket



KKBK-23 Low adjustable bracket



SEN CV 035 Indoor

Specification sheet



Dimensions	H43.2/W39.2/L250-2000mm (H1.70/W1.54/L9.84-78.74in) 1250mm (49.21in) max for UL
PCB Cut-point	250mm (9.84in)
LED Pitch	35mm - 28LED/m (1.38in - 9LED/ft)
Chip	h-line
Cover/Optics	10°/20°/30°/60°/Spread lens (10°x45°)/No lens
CCT	h-line: 2700K/3000K/3500K/4000K/5000K (90CRI for 2700K/3000K)
LED binning	h-line: 3-step MacAdam Ellipse h-line: 4-step MacAdam Ellipse(5000K)
CRI	≥ 90 (2700K/3000K) ≥ 80 (3500K/4000K/5000K)
Lifetime	50,000 hours @ 25°C (50,000 hours @ 77°F)
Operating temp	T _a = -25 to 40°C (T _c max = 80°C) T _a = -13 to 113°F (T _c max = 176°F)
IP Rating	IP40
Finish	Silver anodised
Mounting	Surface mounting via clips or brackets
Power feed	Sheathed hardwire tail
Control	1-10V/DMX/DALI (see visDIM range)



LED Grading Key

Exclusive Grade

h-line*	*KKDC tuned CCT range
Constant Voltage Lensed High Power LED	
3-step CCT range	
(4-step for 5000K)	

Power consumption	Supply voltage	Supply current
40W/m (12.19W/ft)	24V DC	1.67A/m (0.51A/ft)

	Clear Cover 10°	Clear Cover 20°	Clear Cover 30°	Clear Cover Spread lens	Clear Cover No Lens	Clear Cover + Micro Louvre	CRI	R9	Rf	Rg
h-line	3280lm/m (1000lm/ft) 82lm/W	3264lm/m (995lm/ft) 81.6lm/W	3404lm/m (1038lm/ft) 85.1lm/W	3068lm/m (935lm/ft) 76.7lm/W	2780lm/m (847lm/ft) 69.5lm/W	-60% Output when combined with Cover and Lens options	94	65	-	-

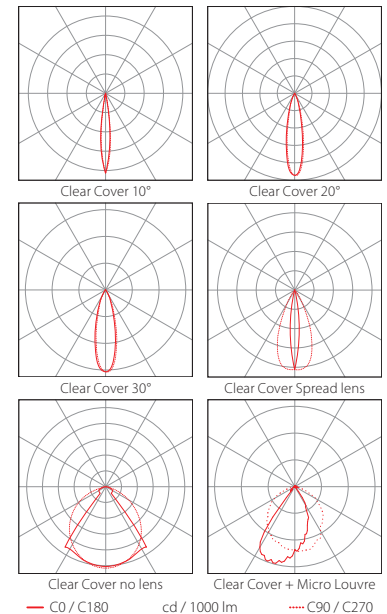
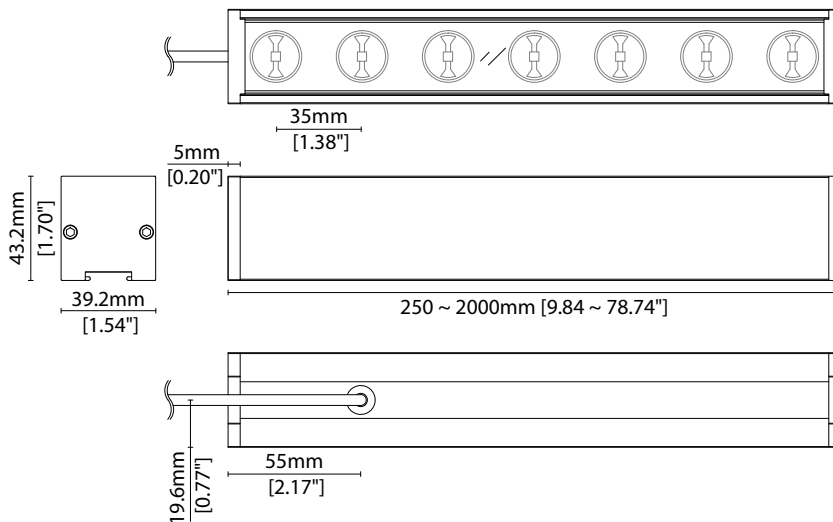

Data derived from independent UKAS/IESNA LM-79-08 accredited testing of production samples.



SEN CV 035 Indoor Code Table



FIXTURE

Model	Finish	Cover/Lens ¹	Grade ²	LED	Colour	Length Availability ³	IP	Cable Length	Power Feed ⁴	Cable Exit ⁵	Lens	Input							
SEN CV Indoor	IS Silver Anodised	SA Clear Clear+ Micro Louvre	B h h K	035	2700K ⁶	27	m 250-2000mm 250mm increments	IP40	40	1000mm 39.37"	1000	Single ø6.3mm sheath tail	S00B	Rear Cable Exit	RC	No lens	XX	DC 24V	g
					3000K ⁶	30								i 9.84-78.74in 9.84in increments	Side Cable Exit ⁷	SC	10°		
					3500K	35	20°								20				
					4000K	40										30°	30		
					5000K	50	(Specify length code OR total run length)							Spread Lens	SL				

¹ Refer to **Cover/Lens Options** on **Options** pages

² Refer to **LED Grading Key** on **Specification sheet** page

³ Refer to **Length Availability List** or enter total run length instead of length code

⁴ Refer to **Power Feed Options** on **Options** pages

⁵ Refer to **Cable Exit Options** on **Options** pages

⁶ 2700K/3000K – 90CRI

⁷ Low adjustable bracket needs side cable exit option

Code Example:

IS	-	SA	-	B	-	h	-	035	-	30	-	m	1250	-	40	-	1000	-	D00B	-	RC	-	30	-	g
SEN CV Indoor	Silver Anodised	Clear	h	035	3000K	1250mm	IP40	1000mm/39.37"	Double ø6.3mm sheath tail	Rear Cable Exit	30°	DC 24V													

ACCESSORIES

Mounting Accessories

KKCP-12	Lock Clip
KKBK-02	Fixed bracket
KKBK-09	Mounting plate
KKBK-16	Small adjustable bracket
KKBK-17	Large adjustable bracket
KKBK-23	Low adjustable bracket

* Refer to **Mounting accessories** on **Accessories** pages

PSU/Driver

1-10V/DALI/DMX

* Refer to **Driver/PSU Options** page for details or provide requirement and KKDC to offer the suitable option

High Power

SEN CV 035 Indoor Length Availability List



Length Code		Fixture Length ¹		LED Strip ²		End Cap Dimension ³		Wattage (W)	Output (lm)
Metric	Imperial(US)	Metric	Imperial(US)	Metric	Imperial(US)	Metric	Imperial(US)		3000K (Test Data)
m0250	i0010	250mm	9.84in	240mm	9.45in	10mm	0.39in	12.00	1241
m0500	i0020	500mm	19.69in	490mm	19.29in	10mm	0.39in	24.50	2533
m0750	i0030	750mm	29.53in	740mm	29.13in	10mm	0.39in	37.00	3826
m1000	i0039	1000mm	39.37in	990mm	38.98in	10mm	0.39in	50.00	5170
m1250	i0049	1250mm	49.21in	1240mm	48.82in	10mm	0.39in	62.00	6411
m1500	i0059	1500mm	59.06in	1490mm	58.66in	10mm	0.39in	74.50	7703
m1750	i0069	1750mm	68.90in	1740mm	68.50in	10mm	0.39in	87.00	8996
m2000	i0079	2000mm	78.74in	1990mm	78.35in	10mm	0.39in	99.50	10288

¹ Actual total overall length of light fixture (LED strip + end caps + void/wire hole)

² Actual length of PCB strip

³ Actual length of 2x end caps

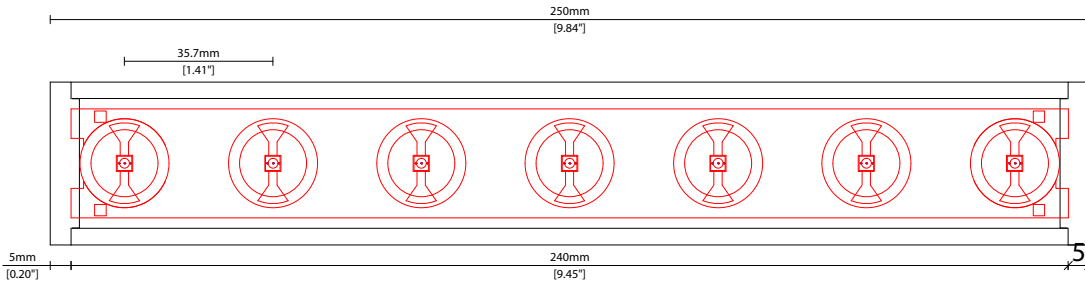

PCB Trim Point

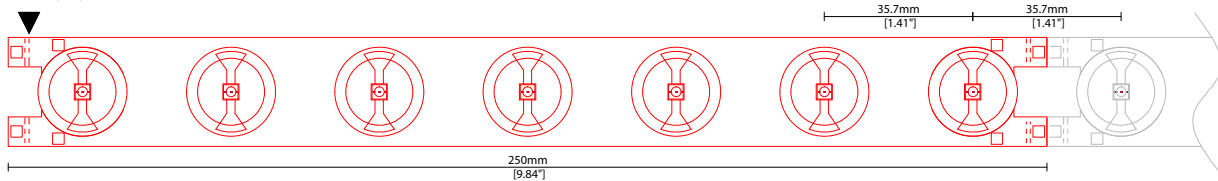

High Power

SEN CV 035 Indoor Options

KKDÖ

COVER/LENS OPTIONS

* Options are an integral part of the fixture ordering codes. Please refer to **Code Table** pages.

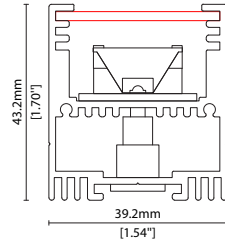

B 10 Clear cover 10° lens
W39.2/H43.2mm (W1.54/H1.70")

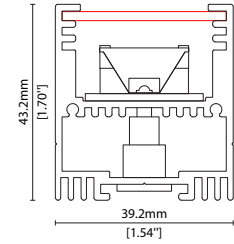

B 20 Clear cover 20° lens
W39.2/H43.2mm (W1.54/H1.70")

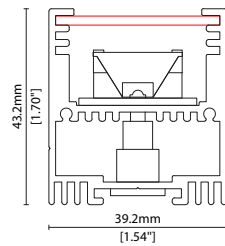

B 30 Clear cover 30° lens
W39.2/H43.2mm (W1.54/H1.70")

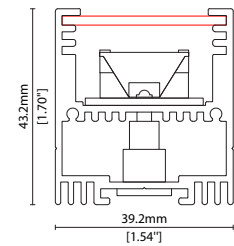

B SL Clear cover + Spread lens
W39.2/H43.2mm (W1.54/H1.70")

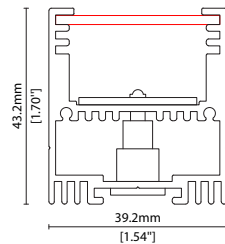

B XX Clear cover No lens
W39.2/H43.2mm (W1.54/H1.70")

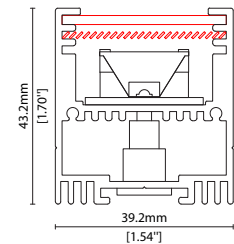

K Clear cover + Micro louvre
W39.2/H43.2mm (W1.54/H1.70")

CABLE EXIT OPTIONS

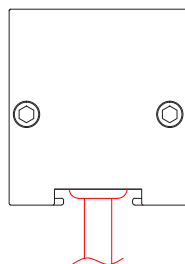

RC Rear cable exit

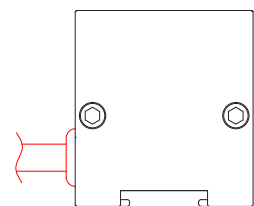

SC Side cable exit



SEN CV 035 Indoor Options



POWER FEED OPTIONS

* Options are an integral part of the fixture ordering codes. Please refer to **Code Table** pages.

1000 S00B 1000mm (39.37") Single ø6.3mm sheath tail

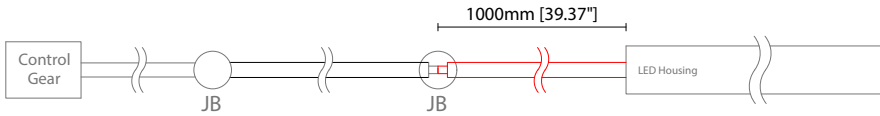

1000 D00B 1000mm (39.37") Double ø6.3mm sheath tail

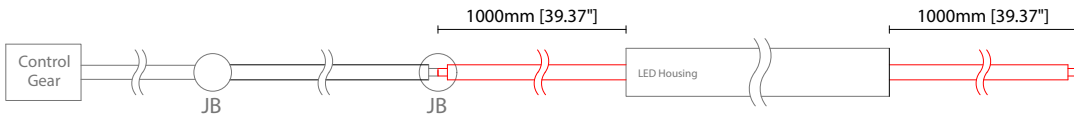

Key

Control Gear Power supply, sub-controllers & control systems
JB Junction box / cable connection

MOUNTING ACCESSORIES

Note: Accessories are to be ordered separately with corresponding code shown below.



KKCP-12

Lock clip (allow 2 per metre/40in)
S/Steel finish

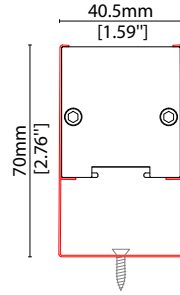

KKBK-02

Fixed bracket (allow 2 per metre/40in)
Steel finish
Pre-assembled for double tail

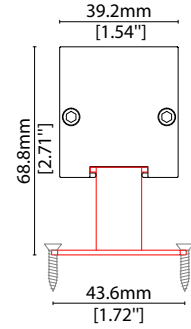

KKBK-09

Mounting plate
(allow 2 per metre/40in – factory fitted)
Silver anodised aluminium finish
Pre-assembled for double tail

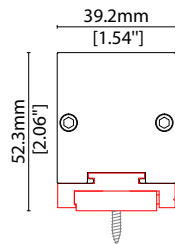

KKBK-23

Low adjustable bracket
(allow 2 per metre/40in)
Silver anodised aluminium finish
Pre-assembled for double tail

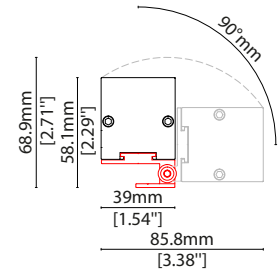

KKBK-16

Small adjustable bracket
(allow 2 per metre/40in)
Silver anodised aluminium finish
Pre-assembled for double tail

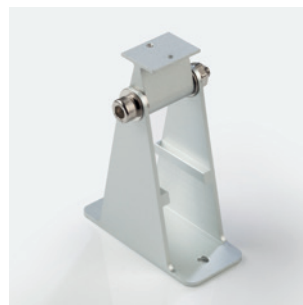
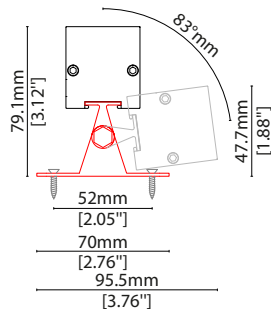

KKBK-17

Large adjustable bracket
(allow 2 per metre/40in)
Silver anodised aluminium finish
Pre-assembled for double tail

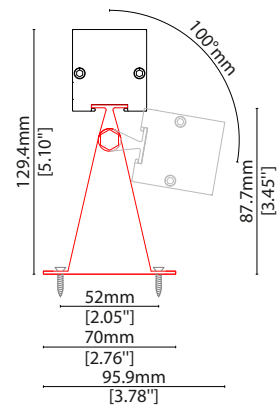



SEN CV 035 Indoor Driver/PSU Options



AVAILABLE PSU OPTIONS

Control Mode	PSU (Order Code)	Input Voltage AC	Output Voltage DC	Rated Output Current	Rated Power	Dim %	IP Rating
Switched	CEN-60-24	90-295V	24V	2.5A	60W	-	IP67
	HLG-60H-24	90-305V	24V	2.5A	60W	-	IP67
	HLG-100H-24	90-305V	24V	4.0A	100W	-	IP67
	HLG-150H-24	90-305V	24V	6.3A	150W	-	IP67
	HLG-240H-24	90-305V	24V	10A	240W	-	IP67
0-10V (1-10V)	PWM-40-24	90-305V	24V	1.67A	40W	100-0.15 (100-10)	IP67
	PWM-60-24	90-305V	24V	2.5A	60W	100-0.15 (100-10)	IP67
	PWM-90-24	90-305V	24V	3.67A	90W	100-0.15 (100-10)	IP67
	PWM-120-24	90-305V	24V	5.0A	120W	100-0.15 (100-10)	IP67
DALI	LIN100A1	120-277V	24V	1A per channel	100W	100-0.1	IP66/IP40
DMX RGB	LIN100A1	120-277V	24V	1.33A per channel	100W	100-0.1	IP66/IP40
DMX RGBW	LIN100A1	120-277A	24V	1A per channel	100W	100-0.1	IP66/IP40

Flicker Free Options - Combination of PSU+ sub-controller

Control Mode	PSU (Order Code)	Sub-controller (Order Code)	Input Voltage AC	Output Voltage DC	Rated Output Current	Rated Power	Dim %	IP Rating PSU/ Sub-controller
0-10V or 1-10V	CEN-60-24	KKDM-06	90-295V	24V	2.5A	60W	100-0.9	IP67/IP20
	HLG-60H-24	KKDM-06	90-295V	24V	2.5A	60W	100-0.9	IP67/IP20
	HLG-100H-24	KKDM-06	90-295V	24V	4.0A	100W	100-0.9	IP67/IP20
	HLG-150H-24	KKDM-06	90-295V	24V	6.3A	150W	100-0.9	IP67/IP20
	HLG-240H-24	KKDM-06	90-295V	24V	10.0A	240W	100-0.9	IP67/IP20
DALI	CEN-60-24	KKDL-02/03	90-295V	24V	2.5A	60W	100-0.1	IP67/IP20
	HLG-60H-24	KKDL-02/03	90-305V	24V	2.5A	60W	100-0.1	IP67/IP20
	HLG-100H-24	KKDL-02/03	90-305V	24V	4.0A	100W	100-0.1	IP67/IP20
	HLG-150H-24	KKDL-02/03	90-305V	24V	6.3A	150W	100-0.1	IP67/IP20
	HLG-240H-24	KKDL-02/03	90-305V	24V	10.0A	240W	100-0.1	IP67/IP20
DMX RGB	CEN-60-24	KKSC-05	90-295V	24V	2.5A	60W	100-0.9	IP67/IP20
	HLG-60H-24	KKSC-05	90-305V	24V	2.5A	60W	100-0.9	IP67/IP20
	HLG-100H-24	KKSC-05	90-305V	24V	4A	100W	100-0.9	IP67/IP20
	HLG-150H-24	KKSC-05	90-305V	24V	6.3A	150W	100-0.9	IP67/IP20
	HLG-240H-24	KKSC-05	90-305V	24V	10.0A	240W	100-0.9	IP67/IP20

¹ The items shown above cover the most frequently used specification but does not exhaust the possible options

² PSU and/or driver can be chosen from the table, or KKDC may recommend the best option upon receipt of the controls requirement and installation environment

³ Electrical shop drawing will include detailed information of PSU and relevant control drivers

⁴ Cut sheets are available on the controls section of www.kkdc.lighting or upon request